

Hazle-  
Luzerne.

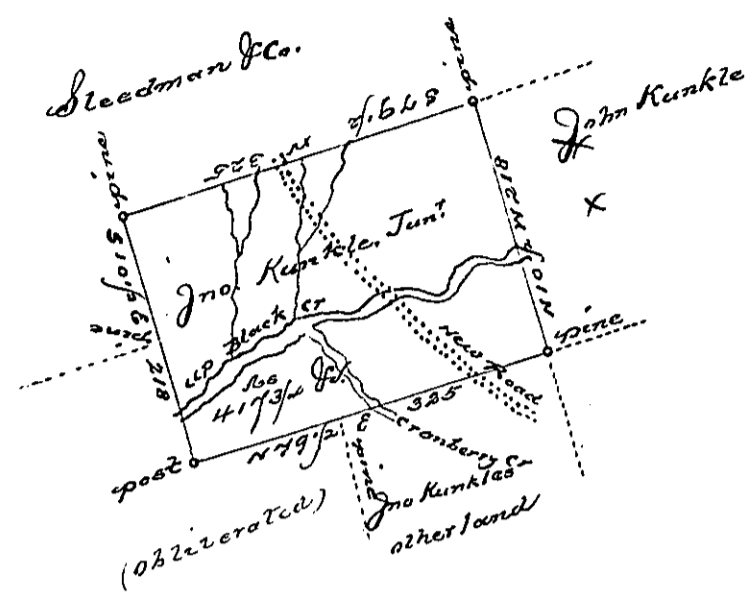

A Draft of a tract of land called Mill Gate. Situate in the county  
 of (obliterated) containing four Hundred & Seventeen acres of land  
 surveyed to John (obliterated) Kunkle the 20th day of Sept: 1793 by virtue of  
 a warrant dated (obliterated) 11th of April 1792.

by W<sup>m</sup> (obliterated)

To  
 Daniel Brodhead Esq<sup>r</sup> }  
 Suror<sup>g</sup> Gen<sup>l</sup> }

IN TESTIMONY that the above is a copy of the original remaining on file in the  
 Department of Internal Affairs of Pennsylvania, made con-  
 formably to an Act of Assembly approved the 16th day of  
 February, 1833. I have hereunto set my Hand and caused  
 the Seal of said Department to be affixed at Harrisburg, this

Third day of October, 1895.

James W. Latta  
 Secretary of Internal Affairs.